

HIGH TORQUE HYBRID STEPPING MOTOR SPECIFICATIONS

General specifications		Electrical specifications	
Step Angle (°)	1.8	Rated Voltage (V)	4.25
Temperature Rise (°C)	80 Max (rated current, 2 phase on)	Rated Current (A)	0.86
Ambient temperature (°C)	-20~+50	Resistance Per Phase ($\pm 10\%$)	4.94 (25°C)
Number of Phase	2	Inductance Per Phase ($\pm 20\%$ mH)	11.45
Insulation Resistance	100M Ω , Min (500VDC)	Holding Torque (Kg.cm)	7
Insulation Class	Class B	Detent Torque (g.cm)	300
Max.radial force (N)	28 (20mm from the flange)	Rotor Inertia (g.cm ²)	95
Max.axial force (N)	10	Weight (Kg)	0.48

● Pull out torque curve:

VOLTAGE: 28VDC, CONSTANT CURRENT: 0.86A, HALF STEP

● Wiring Diagram:

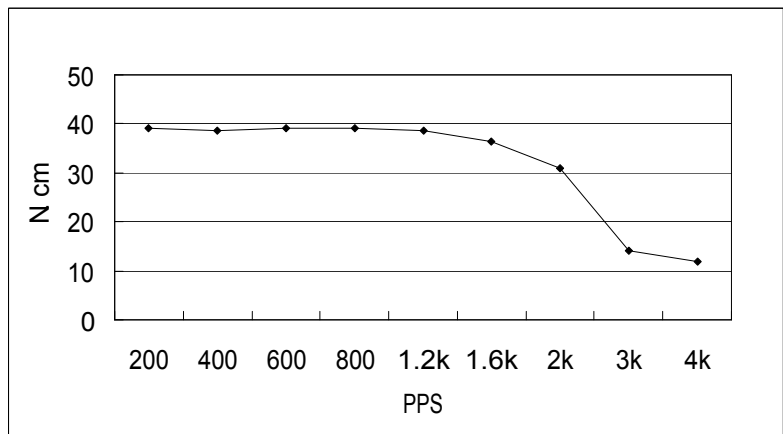
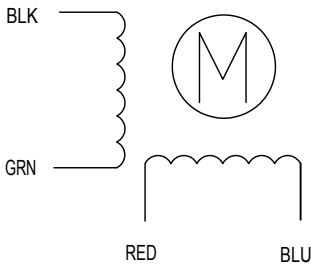

● Dimensions:
(unit=mm)

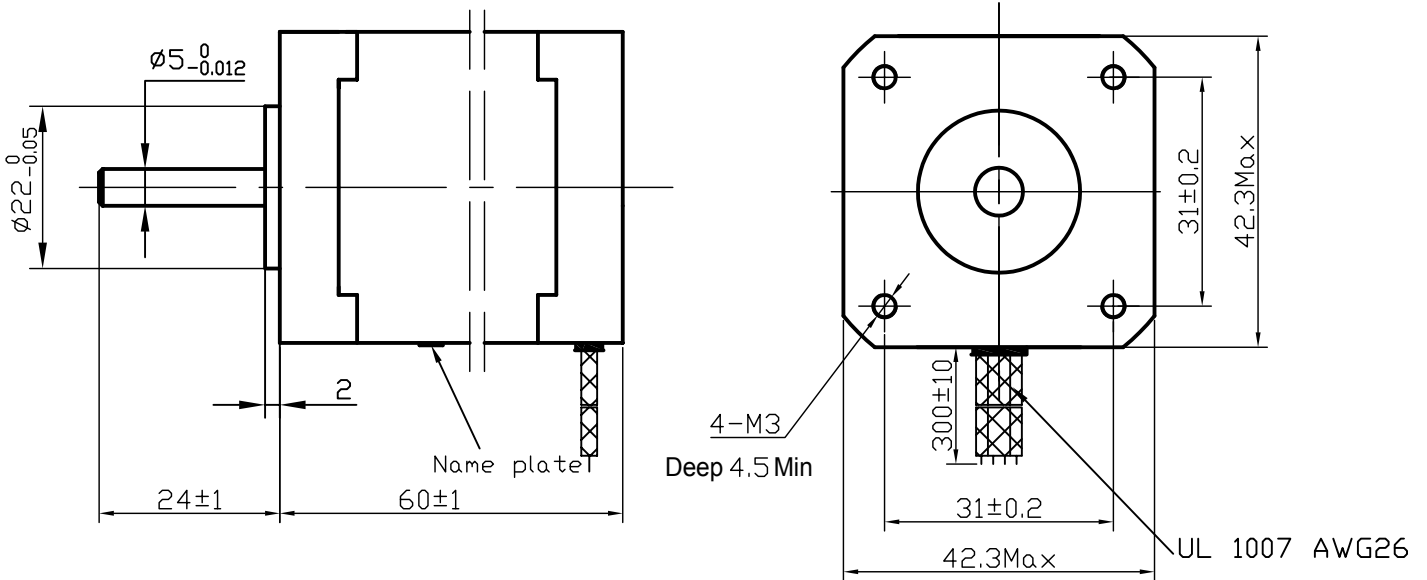

△						NOV42STH60-0864A	TECHNICAL CONDITIONS
△							
REV	REVISIONS	DESCRIPTION	BY	DATE			
DRAW							
CHECK						NOVOMOTEC GmbH	
APPROVE							

This document was created with Win2PDF available at <http://www.daneprairie.com>.
The unregistered version of Win2PDF is for evaluation or non-commercial use only.