

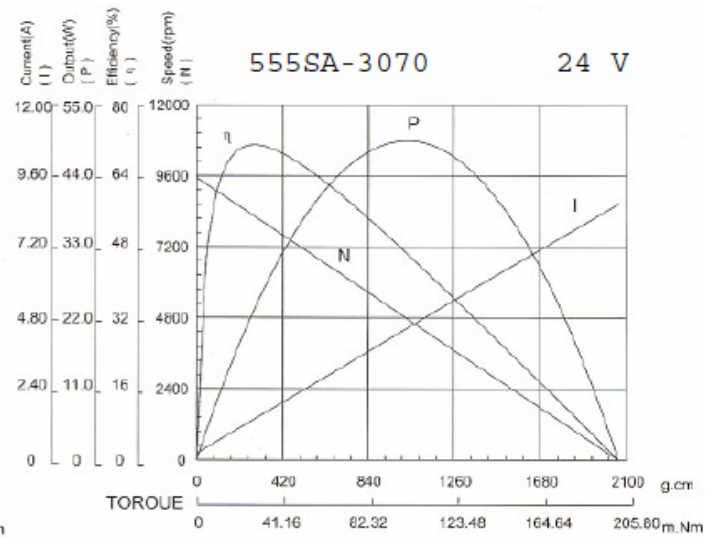

## DC3657CL-S550/555SA

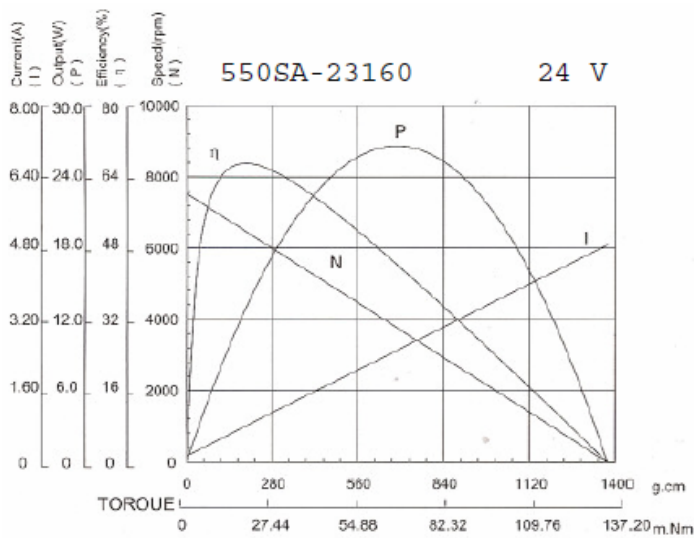
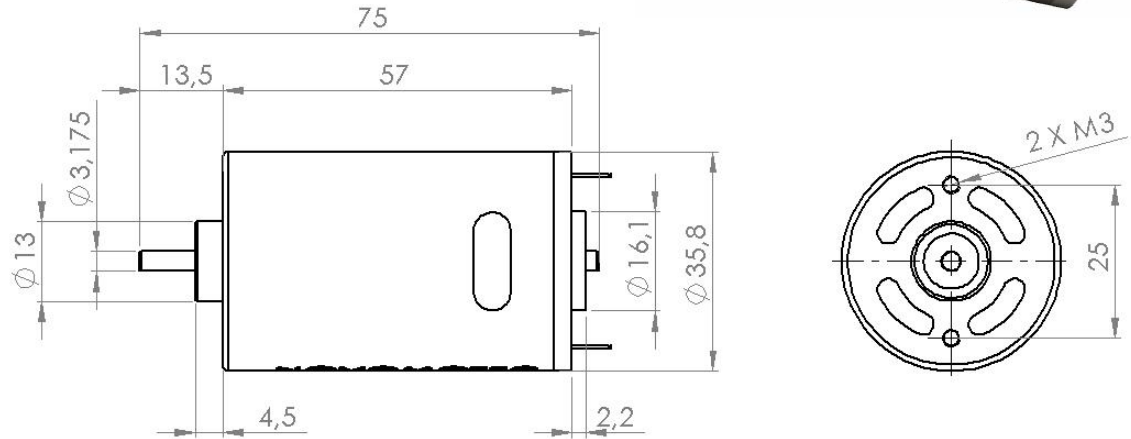

Motor		550SA		555SA	
Model		23160	12240	3544	3070
Nennspannung	V	24	24	12	24
Leerlaufdrehzahl	1/min	7535	4864	7185	9531
Leerlaufstrom	A	0,133	0,076	0,232	0,216
Nenn-drehzahl	1/min	6467	3901	6158	8231
Nennmoment	mNm	19,11	10,33	20,13	27,55
Nennstrom	A	0,805	0,308	1,391	1,368
Anhaltmoment	mNm	134,75	52,21	140,83	202,00
Anhaltstrom	A	4,872	1,248	8,337	8,659
opt. Wirkungsgrad	%	70	k.A.	k.A.	72